

ANDERSON & SENN

COMMERCIAL REAL ESTATE

FOR LEASE



620 California Blvd, Suite G

Property Description:

City: San Luis Obispo, CA

Size: 3,098 Square Feet

Price: \$2.75/Square Foot, NNN

Type: Dental or Medical Office

Notes: This suite is currently set up for pediatric dentistry. The California Medical Center is well-located, just off Highway 101. Excellent on-site parking.

DEREK SENN

805.543.1400
798 PALM ST, SLO, CA 93401
www.Anderson-Senn.com
DRE #001252131

ANDERSON & SENN

COMMERCIAL REAL ESTATE

620 CALIFORNIA
SUITE #G



DEREK SENN

805.543.1400
798 PALM ST, SLO, CA 93401
www.Anderson-Senn.com
DRE #001252131

INFORMATION CONTAINED HEREIN HAS BEEN OBTAINED FROM SOURCES WE DEEM RELIABLE. WHILE WE HAVE NO REASON TO DOUBT ITS ACCURACY WE DO NOT GUARANTEE IT.

ANDERSON & SENN

COMMERCIAL REAL ESTATE

620 CALIFORNIA SUITE #G

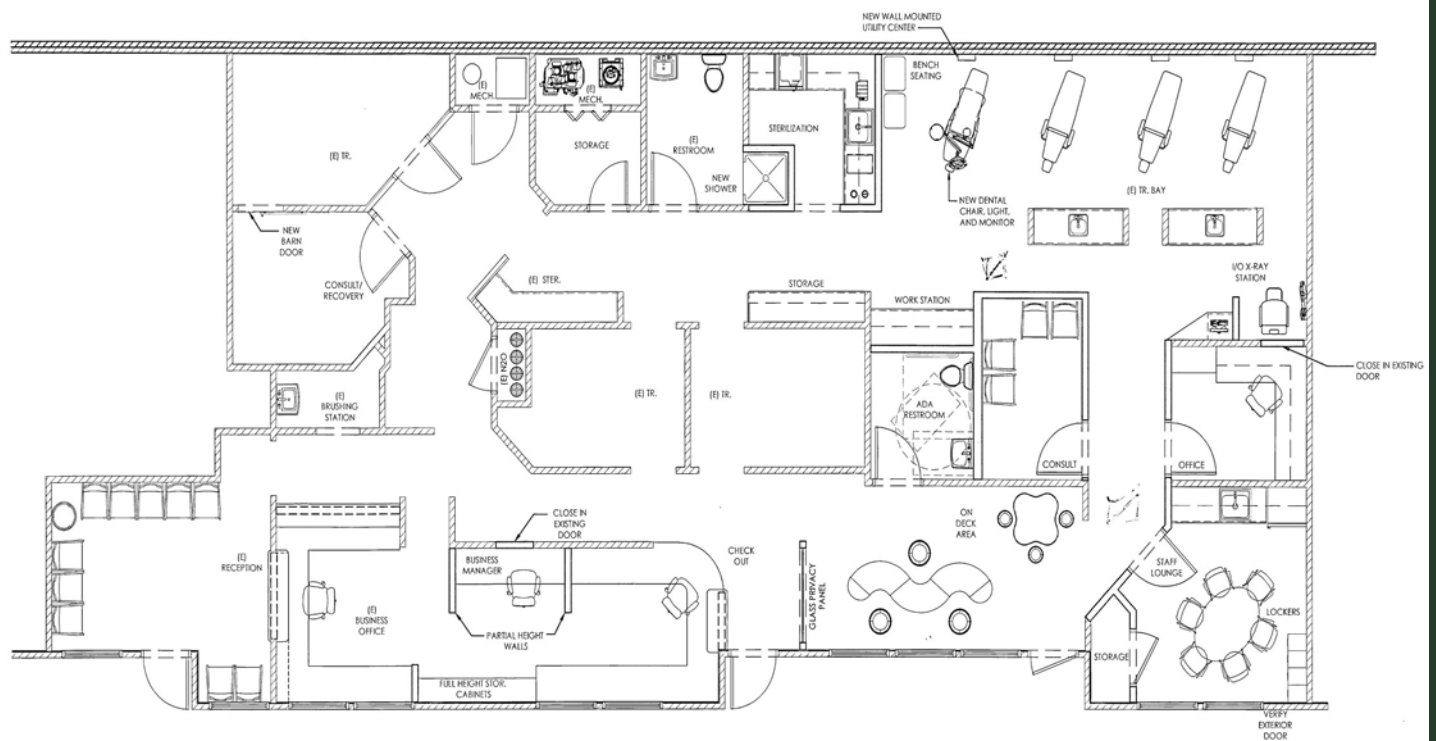

DEREK SENN

805.543.1400
798 PALM ST, SLO, CA 93401
www.Anderson-Senn.com
DRE #001252131

ANDERSON & SENN

COMMERCIAL REAL ESTATE

620 CALIFORNIA SUITE #G



DEREK SENN

805.543.1400
798 PALM ST, SLO, CA 93401
www.Anderson-Senn.com
DRE #001252131